

Town of Ludlow

ACCESSORY BUILDINGS- SHED-BARN-CARPORT

Permit Requirements:

- Permits are required for sheds and accessory buildings **200 square feet and over**
- **Plot Plan is required**
- Fees: \$.50 per square foot- \$100.00 minimum – less than 400 square feet
\$.50 per square foot- \$175.00 minimum – 400 square feet or more
- Accessory buildings under 400 square feet in area and 10' or less eaves height:
 - Requires minimum of approved tie-down system **with spec sheets**
 - **Plans required**
- Accessory buildings 400 square feet in area and over **OR** over 10' eaves height:
 - Requires a foundation system (4' frost walls or sonotubes/piers- 48" below finished grade)
 - **Plans required**
 - Garages with curb cuts need footings/foundation system
- One-story buildings or structures, including garages, shall not exceed seventeen (17) feet in height
- Two-story accessory building shall not exceed twenty-five (25) feet in height
- An unattached one-story accessory building shall be placed no nearer than five (5) feet to a side lot line and five (5) feet to a rear lot line
- An unattached two-story accessory structure shall be placed no nearer than ten (10) feet to a side lot line and ten (10) feet to a rear lot line
- Total area for all unattached accessory structures in all residential districts is limited in size not to exceed fifty percent (50%) of square footage for the principal structure

CHECKLIST

- ☐ Application (Residential One- & Two-Family Building Permit) filled out completely
- ☐ Plot Plan with measurements from lot lines and any additional structures on property
- ☐ Certificate of Liability Insurance/Workers Comp Insurance- **Contractor**
- ☐ Copy of Home Improvement Contractor Registration (HIC)-**Contractor**
- ☐ Worker's Comp Affidavit
- ☐ Homeowner Exemption Form - filled out by homeowner if not being done by a contractor/company



TOWN OF LUDLOW
The Commonwealth of Mass. State Board of Building Regulations and Standards
Massachusetts State Building Code, 780 CMR, 9th edition
BUILDING PERMIT APPLICATION TO CONSTRUCT, REPAIR, RENOVATE OR DEMOLISH A
ONE- OR TWO-FAMILY DWELLING



Official Use Only:

DATE SUBMITTED: _____ **FEE: \$** _____ **Indicate how fee is determined**

☐ Standard Town Application Fee ☐ Total Project Cost (Item 6 of Estimated Project Cost x multiplier) _____ X _____

Other Fees \$ _____ List: _____

SIGNED: _____ **DATE ISSUED** _____
Building Commissioner / Inspector of Buildings

SECTION 1 – SITE

Property Address: _____ Zoning District: _____

Is this an accepted street? yes ☐ no ☐ Assessors' Map #: _____ Parcel # _____ Proposed Use: _____

Property Dimensions: Lot Area (sq. ft.): _____ Frontage (ft.): _____ Year Constructed: _____

BUILDING SETBACKS (FT.)

Front Yard: Required: _____ Provided: _____ Side Yards: Required: _____ / _____ Provided: _____ / _____ Rear Yard: Required: _____ Provided: _____

Water Supply: Public ☐ Private ☐ Sewage Disposal System: Municipal ☐ Onsite disposal system ☐ Flood Zone: _____ Outside Flood Zone ☐

SECTION 2 – PROPERTY OWNERSHIP

Owner of Record: _____ Phone: _____

Mailing Address: _____ Cell: _____

Email Address: _____

SECTION 3 – DESCRIPTION OF PROPOSED WORK (check all that apply)

☐ NEW CONSTRUCTION ☐ OWNER-OCCUPIED ☐ REPAIRS ☐ REMODEL ☐ ADDITION ☐ DEMOLITION
☐ EXISTING BUILDING ☐ ACCESSORY BUILDING ☐ OTHER Specify: _____

TOTAL SQUARE FOOTAGE OF CONSTRUCTION _____ TOTAL PROJECT COST \$ _____
(Including Electrical , Plumbing, Gas, HAVC, Fire Suppression)

Complete description of work: _____

SECTION 4 – DEPARTMENT APPROVALS FOR RESIDENTIAL BUILDINGS

Department	Approved	Date	N/A	Department	Approved	Date	N/A
Board of Appeals- Variances				D.P.W. - St. Opening			
Board of Health- Septic/Well/Bedroom				D.P.W. - Sewer			
Conservation Commission				D.P.W. - Storm Water			
Planning- Sub-Divisions				Fire- Life Safety			
Tax Collector Taxes							

SECTION 5 – CONSTRUCTION SERVICES

Construction Supervisor / H.I. Contractor _____		
Print Name & Company Name		
Phone: _____	Email: _____	Cell: _____
Address: _____		
Signature: _____		
Construction Supervisor's License #: _____ Expiration Date: _____		Check CSL Type: <input type="checkbox"/> U-Unrestricted (up to 35,000 Cu. Ft.) <input type="checkbox"/> R-Restricted 1 & 2 family dwelling <input type="checkbox"/> M-Masonry Only <input type="checkbox"/> RC-Residential Roof Covering <input type="checkbox"/> WS-Residential Window & Siding <input type="checkbox"/> SF-Res. Solid Fuel Burning Appl. Inst. <input type="checkbox"/> D-Residential Demolition <input type="checkbox"/> IC-Insulation
H.I.C. Registration # _____ Expiration Date: _____		
Architect: _____ Phone: _____		
Address: _____		

SECTION 6 – OWNER AUTHORIZATION

I, _____ as Owner of the aforementioned property hereby authorize
(Print Name of Owner)

_____ to act on my behalf during the work authorized pursuant to this application
(Print Name of Agent)

Owners pulling their own permit or dealing with unregistered contractors do not have access to the Arbitration Program or Guaranty Fund (as set forth in MGL c. 142A)

Signature of Owner: _____ **Date:** _____

Owner Email: _____

SECTION 7 – OWNER / AUTHORIZED AGENT DECLARATION

I, _____, as Owner / Authorized Agent hereby declare that the information contained in this application is a true and accurate description of the proposed work and costs associated therewith. I agree that the proposed work shall be completed subject to the provisions of the Massachusetts State Building Code and other applicable laws and ordinances.

Signature of Owner / Agent: _____ Date: _____

SECTION 8 – DEMOLITION REQUIREMENTS

DIG SAFE #: _____

(Letters required from utilities)

1-888-DIG-SAFE

<input type="checkbox"/> Gas Co.	<input type="checkbox"/> Electric Co.	<input type="checkbox"/> Water Supplier	<input type="checkbox"/> Sewer (D.P.W.)	<input type="checkbox"/> Telephone Co.
<input type="checkbox"/> Dept. of Labor & Industries (Asbestos/Lead) 413-781-2676	<input type="checkbox"/> Board of Health	<input type="checkbox"/> Fire Department	<input type="checkbox"/> Planning Board	

SECTION 9 – DEBRIS DISPOSAL

In accordance with the provisions of MGL, C.0, S.4, a condition of this Building Permit is that the debris resulting from this work shall be disposed of in a properly licensed solid waste disposal facility as defined by MGL C111, S151A.

NAME & LOCATION OF FACILITY: _____

SIGNATURE OF PERMIT APPLICANT: _____ **DATE:** _____

SECTION 10 – WORKERS' COMPENSATION INSURANCE AFFIDAVIT (M.G.L. c.152 §25C(6))

Workers' Compensation Insurance affidavit must be completed and submitted with this application. Failure to provide this affidavit will result in the denial of the Issuance of the building permit.

Signed Affidavit Attached? Yes.....☐ No.....☐



The Commonwealth of Massachusetts
Department of Industrial Accidents
1 Congress Street, Suite 100
Boston, MA 02114-2017
www.mass.gov/dia

Workers' Compensation Insurance Affidavit: Builders/Contractors/Electricians/Plumbers.
TO BE FILED WITH THE PERMITTING AUTHORITY.

Applicant Information

Please Print Legibly

Name (Business/Organization/Individual): _____

Address: _____

City/State/Zip: _____ Phone #: _____

Are you an employer? Check the appropriate box:

1. ☐ I am an employer with _____ employees (full and/or part-time).*
2. ☐ I am a sole proprietor or partnership and have no employees working for me in any capacity. [No workers' comp. insurance required.]
3. ☐ I am a homeowner doing all work myself. [No workers' comp. insurance required.] †
4. ☐ I am a homeowner and will be hiring contractors to conduct all work on my property. I will ensure that all contractors either have workers' compensation insurance or are sole proprietors with no employees.
5. ☐ I am a general contractor and I have hired the sub-contractors listed on the attached sheet. These sub-contractors have employees and have workers' comp. insurance.‡
6. ☐ We are a corporation and its officers have exercised their right of exemption per MGL c. 152, §1(4), and we have no employees. [No workers' comp. insurance required.]

Type of project (required):

7. ☐ New construction
8. ☐ Remodeling
9. ☐ Demolition
10. ☐ Building addition
11. ☐ Electrical repairs or additions
12. ☐ Plumbing repairs or additions
13. ☐ Roof repairs
14. ☐ Other _____

*Any applicant that checks box #1 must also fill out the section below showing their workers' compensation policy information.

† Homeowners who submit this affidavit indicating they are doing all work and then hire outside contractors must submit a new affidavit indicating such.

‡ Contractors that check this box must attach an additional sheet showing the name of the sub-contractors and state whether or not those entities have employees. If the sub-contractors have employees, they must provide their workers' comp. policy number.

I am an employer that is providing workers' compensation insurance for my employees. Below is the policy and job site information.

Insurance Company Name: _____

Policy # or Self-ins. Lic. #: _____ Expiration Date: _____

Job Site Address: _____ City/State/Zip: _____

Attach a copy of the workers' compensation policy declaration page (showing the policy number and expiration date).

Failure to secure coverage as required under MGL c. 152, §25A is a criminal violation punishable by a fine up to \$1,500.00 and/or one-year imprisonment, as well as civil penalties in the form of a STOP WORK ORDER and a fine of up to \$250.00 a day against the violator. A copy of this statement may be forwarded to the Office of Investigations of the DIA for insurance coverage verification.

I do hereby certify under the pains and penalties of perjury that the information provided above is true and correct.

Signature: _____ Date: _____

Phone #: _____

Official use only. Do not write in this area, to be completed by city or town official.

City or Town: _____ Permit/License # _____

Issuing Authority (circle one):

1. Board of Health 2. Building Department 3. City/Town Clerk 4. Electrical Inspector 5. Plumbing Inspector
6. Other _____

Contact Person: _____ Phone #: _____

Information and Instructions

Massachusetts General Laws chapter 152 requires all employers to provide workers' compensation for their employees. Pursuant to this statute, an **employee** is defined as "...every person in the service of another under any contract of hire, express or implied, oral or written."

An **employer** is defined as "an individual, partnership, association, corporation or other legal entity, or any two or more of the foregoing engaged in a joint enterprise, and including the legal representatives of a deceased employer, or the receiver or trustee of an individual, partnership, association or other legal entity, employing employees. However the owner of a dwelling house having not more than three apartments and who resides therein, or the occupant of the dwelling house of another who employs persons to do maintenance, construction or repair work on such dwelling house or on the grounds or building appurtenant thereto shall not because of such employment be deemed to be an employer."

MGL chapter 152, §25C(6) also states that **"every state or local licensing agency shall withhold the issuance or renewal of a license or permit to operate a business or to construct buildings in the commonwealth for any applicant who has not produced acceptable evidence of compliance with the insurance coverage required."**

Additionally, MGL chapter 152, §25C(7) states "Neither the commonwealth nor any of its political subdivisions shall enter into any contract for the performance of public work until acceptable evidence of compliance with the insurance requirements of this chapter have been presented to the contracting authority."

Applicants

Please fill out the workers' compensation affidavit completely, by checking the boxes that apply to your situation and, if necessary, supply sub-contractor(s) name(s), address(es) and phone number(s) along with their certificate(s) of insurance. Limited Liability Companies (LLC) or Limited Liability Partnerships (LLP) with no employees other than the members or partners, are not required to carry workers' compensation insurance. If an LLC or LLP does have employees, a policy is required. Be advised that this affidavit may be submitted to the Department of Industrial Accidents for confirmation of insurance coverage. **Also be sure to sign and date the affidavit.** The affidavit should be returned to the city or town that the application for the permit or license is being requested, **not** the Department of Industrial Accidents. Should you have any questions regarding the law or if you are required to obtain a workers' compensation policy, please call the Department at the number listed below. Self-insured companies should enter their self-insurance license number on the appropriate line.

City or Town Officials

Please be sure that the affidavit is complete and printed legibly. The Department has provided a space at the bottom of the affidavit for you to fill out in the event the Office of Investigations has to contact you regarding the applicant. Please be sure to fill in the permit/license number which will be used as a reference number. In addition, an applicant that must submit multiple permit/license applications in any given year, need only submit one affidavit indicating current policy information (if necessary) and under "Job Site Address" the applicant should write "all locations in _____(city or town)." A copy of the affidavit that has been officially stamped or marked by the city or town may be provided to the applicant as proof that a valid affidavit is on file for future permits or licenses. A new affidavit must be filled out each year. Where a home owner or citizen is obtaining a license or permit not related to any business or commercial venture (i.e. a dog license or permit to burn leaves etc.) said person is NOT required to complete this affidavit.

The Department's address, telephone and fax number:

The Commonwealth of Massachusetts
Department of Industrial Accidents
1 Congress Street, Suite 100
Boston, MA 02114-2017

Tel. # 617-727-4900 ext. 7406 or 1-877-MASSAFE
Fax # 617-727-7749
www.mass.gov/dia

DEPARTMENT OF INSPECTIONAL SERVICES
TOWN OF LUDLOW
LUDLOW, MASSACHUSETTS 01056
PHONE (413) 583-5600 ext. 1210

HOMEOWNER LICENSE EXEMPTION
(PLEASE PRINT)

DATE: _____

HOMEOWNER:
(Name/Address) _____

JOB LOCATION: _____
(Address OR Map & Lot)

TYPE OF WORK: _____

The current exemption for "homeowners" was extended to include Owner-Occupied Dwellings of two units or less and to allow such homeowner to engage an individual for hire who does not possess a license, provided that the owner acts as supervisor (State Building Code Section 108.3.5.1).

DEFINITION OF HOMEOWNER: Person (s) who own a parcel of land on which he/she resided or intends to reside, on which there is, or is intended to be, a one or two family dwelling, attached or detached structures accessory to such use and/or farm structures. A person who constructs more than one home in a two-year period shall not be considered a homeowner. Such "homeowner" shall submit to the Building Official, on a form acceptable to the Building Official, that he/she shall be responsible for all such work performed under the building permit.*

As acting Construction Supervisor/General Contractor your presence on the job site will be required from time to time, during and upon completion of the work for which this permit is issued.

Also be advised that with reference to Chapter 152 (**Workers' Compensation**) and Chapter 153 (**Liability of Employers to Employees Laws Annotated**), you may be liable for persons (s) you hire to perform work for you under this permit.

The undersigned "Homeowner" certifies and assumes responsibility for compliance with the State Building Code, Town of Ludlow Bylaws, Rules and Regulations, State and Local Zoning Laws, and State of Massachusetts General Laws Annotated.

***NOTICE IS HEREBY GIVEN THAT OWNERS PULLING THEIR OWN PERMIT OR DEALING WITH UNREGISTERED CONTRACTORS FOR APPLICABLE HOME IMPROVEMENT DO NOT HAVE ACCESS TO THE ARBITRATION PROGRAM OR GUARANTY FUND UNDER M.G.L. c.142A.**

HOMEOWNER SIGNATURE: _____
Signed under penalties of perjury



Office of Consumer Affairs and Business Regulation

Warning

HOMEOWNERS SHOULD NOT APPLY FOR THEIR OWN BUILDING PERMIT

Under the Home Improvement Contractor (HIC) Law, M.G.L. c. 142A, when a homeowner hires a contractor to perform residential contracting work, the contractor should obtain the building permit, unless one is not necessary. If you, the homeowner, obtain the permit, be aware of the following:

- You are now personally responsible for all work on this project.
- You are the General Contractor of the project and a court of law will view you as such if you are sued, or if you sue another party.
- You are responsible for ensuring that all work meets the MA Building Code.
- You must supervise the work.
- You must call your municipal Building Department to schedule all required inspections.
- Your subcontractors may lien your property.
- Any worker injured on your project may sue you if you do not carry Workers' Compensation insurance.
- Failure to carry Workers' Compensation insurance may result in serious penalties.
- **You have waived all rights to the Guaranty Fund.**

For more information about the HIC Law or the HIC Programs, contact our Consumer Hotline at 617-973-8787 or visit us at [Mass.Gov/HomeImprovement](https://www.mass.gov/homeimprovement)

Town Of Ludlow Plot Plan

ADDRESS: _____

DATE: _____

OWNER OF LAND: _____

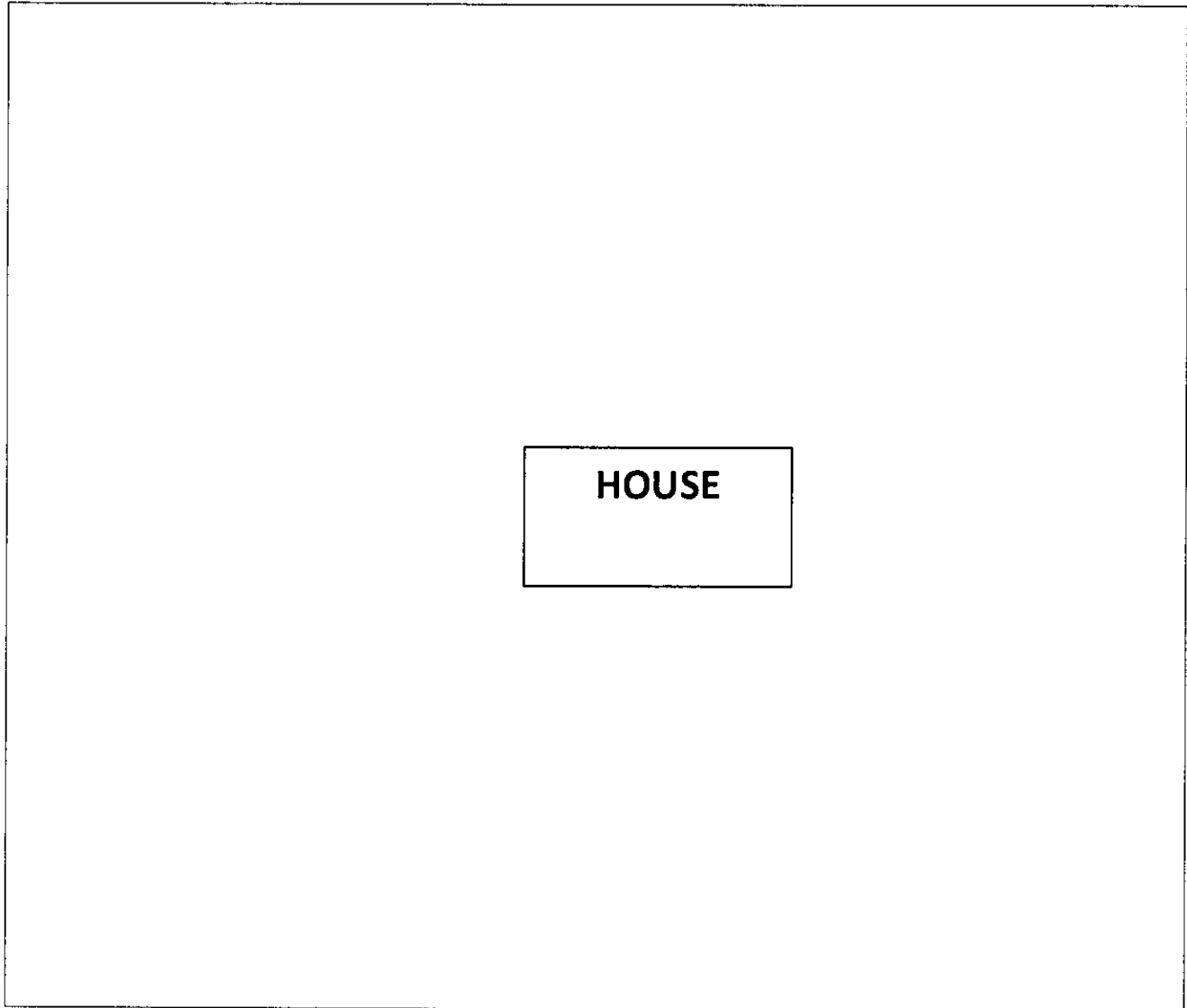

SIDEWALK

STREET/AVENUE/ROAD _____

PLEASE ADD ANY STRUCTURES, FREATURES AND IMPROVEMENTS

Town Of Ludlow Plot Plan

ADDRESS: _____

OWNER OF LAND: _____

The diagram is a plot plan for a property. It features a central rectangle labeled "HOUSE". Surrounding the house are four yard areas, each defined by a dashed line and a vertical tick mark. The "Rear yard" is at the top, with a vertical dashed line and a tick mark labeled "____ FT". The "Front yard" is at the bottom, with a vertical dashed line and a tick mark labeled "____ FT". The "Side yard" is on the left, with a horizontal dashed line and a tick mark labeled "____ FT". The "Side yard" is on the right, with a horizontal dashed line and a tick mark labeled "____ FT".

SIDEWALK

STREET/AVENUE/ROAD _____

PLEASE ADD ANY STRUCTURES, FREATURES AND IMPROVEMENTS