



Town of Ludlow Department of Public Works
198 Sportsmen's Road, Ludlow, MA 01056
TEL: (413) 583-5625 FAX: (413) 589-1488

PERMIT APPLICATION CONSTRUCTION WITHIN THE PUBLIC WAY

FOR OFFICE USE ONLY:

Permit # _____

Fee: _____

Performance Security: _____

Guarantee Security: _____

DATE: _____

DIG SAFE NO.: _____

TRENCH PERMIT (*circle one*): YES NO N/A

LOCATION OF PROPOSED WORK: _____

Name of Owner

Name of Contractor

Street Address

Street Address

Town

Town

Contact Name / Telephone #

Contact Name / Telephone #

Application and Site Plan shall be submitted to the DPW no less than five (5) working days prior to the schedule of construction for processing. See sample exhibit attached.

Contractor shall notify the DPW for an inspection 24 hours prior to construction.

A separate Sewer Connection Permit is required for service lateral installation. Work shall be performed by a licensed drain layer in the Town of Ludlow.

Construction shall be in conformance with Department of Public Works Standards and Specifications and this application.

Is There Existing Sidewalk?: _____ Is There Existing Curbing?: _____

A. DRIVEWAY INSTALLATION (Driveway must be paved from edge of road to property line)

Width of Driveway: _____ Distance from Property Line: _____

Is this a Corner Lot?: _____ Driveway material: _____

This permit is valid for 1 year from the date of issue, after 1 year you must apply for a new permit.

B. UTILITY INSTALLATION

Type of Utility to be installed: _____

Width of trench: _____ Length of trench: _____ Depth of trench: _____

Trench Backfill: Method No. 1: _____ Method No. 2: _____

Sewer Connection Permit No.: _____ Drain layer: _____

C. OTHER CONSTRUCTION (Describe work to be conducted within the Public Way other than a driveway or utility installation. List the width and length of roadway cut, if any.)

POLICE DEPARTMENT REVIEW

Traffic Control Officer required: Yes _____ or No _____ Number Required: _____

Comments: _____

Reviewed by: _____ Date: _____

DEPARTMENT OF PUBLIC WORKS REVIEW

Comments: _____

Permit Recommended: _____ Date: _____

Permit Approved: _____ Date: _____

Application Denied: _____ Date: _____



Approval is given for the limited purpose of review and action by the Building Inspector only and not for the purpose of actual construction and/or reconstruction within the Public Way.

TOWN OF LUDLOW HOLD HARMLESS AGREEMENT

AGREEMENT made on this date, _____, by and between the Town of Ludlow, Massachusetts a municipal corporation with a place of business at 488 Chapin Street, Ludlow, Massachusetts, acting by and through its Department of Public Works (the "Town" and _____ (applicant) of _____ (address)

The Applicant has requested permission of the Town to construct a (type of project) _____ on (location) _____

within the public way in the Town of Ludlow. The Town is willing to grant such permission, subject to any established restrictions contained in the permit application, based on the terms and conditions as set forth in this agreement. The parties, therefore, agree as follows:

1. The Town grants the applicant the right to construct the project described above within the public way.
2. The applicant agrees to maintain, repair and replace said project as may be necessary at any time after its installation, and said obligations to maintain, repair and replace shall apply to all parts of the project, including those parts within the Public Way.
3. The applicant hereby Holds Harmless the Town for any further maintenance, repair, and/or replacement of the project.
4. This agreement sets forth the entire understanding and agreement of the parties hereto with respect to the subject matter hereof, and no change of modification shall be valid unless made in writing and signed by the parties hereto.
5. This agreement and the construction and interpretation of all provisions hereto shall be governed by the laws of the Commonwealth of Massachusetts.

IN WITNESS WHEREOF, the parties have executed as of the date first written above.

TOWN OF LUDLOW

APPLICANT

Department of Public Works

KEY:

- A.** Location Tie
- B.** Width of Driveway
- C.** Dimension From Driveway To Property Line

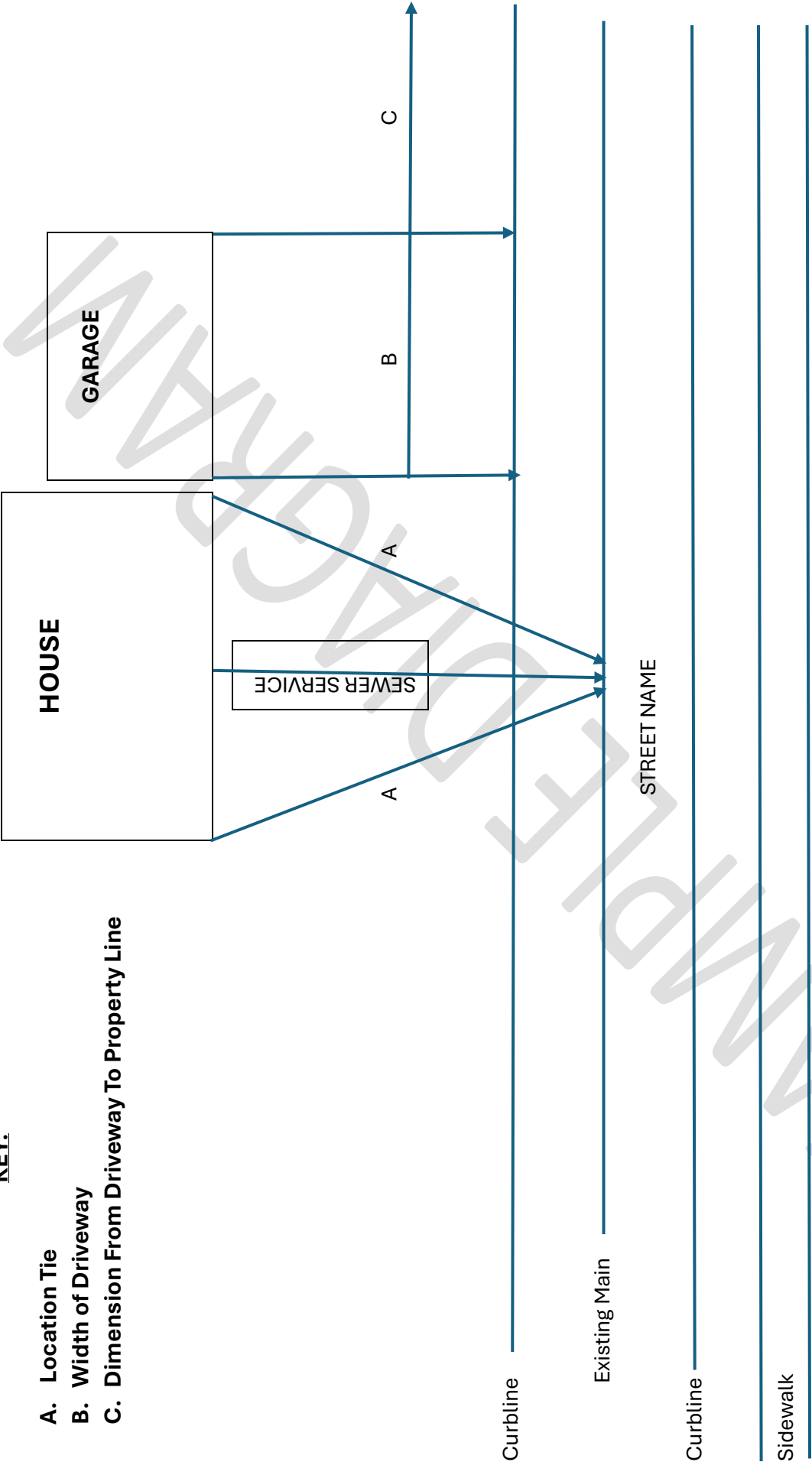

ADDRESS _____ ASSESSOR MAP NO. _____ LOT NO. _____